

# Conference Floor Plan and Capacities

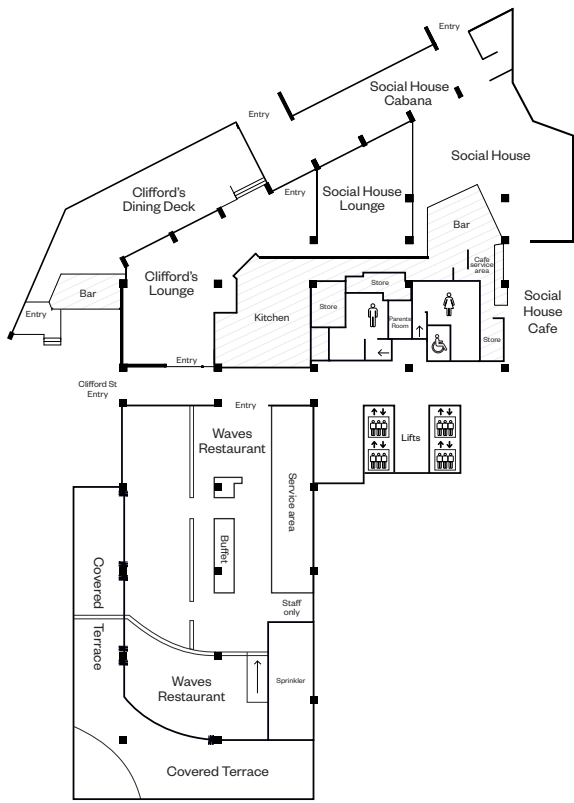

**GROUND**

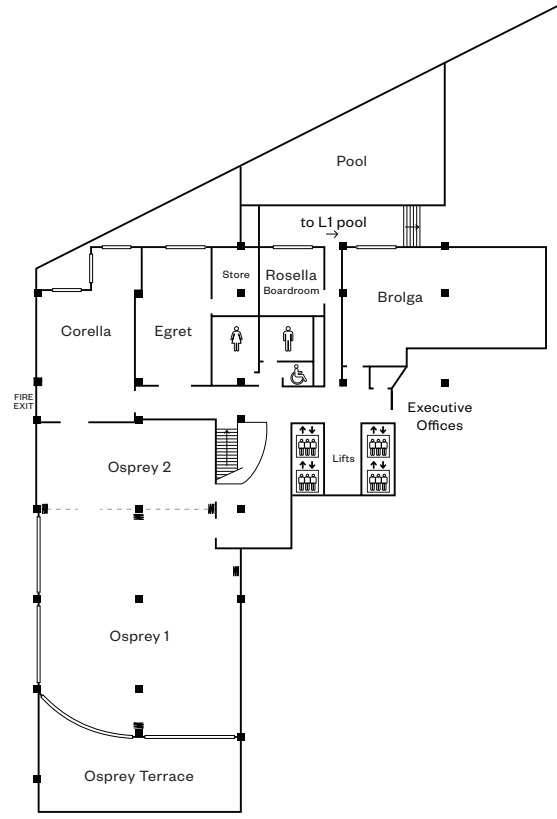

**LEVEL 1**

MEETING ROOM / LEVEL	SQ M	SEATED	COCKTAIL
----------------------	------	--------	----------

**GROUND**

Clifford's Grill & Lounge - overall	230	126	160
Clifford's Grill & Lounge - deck	92	56	60
Clifford's Grill & Lounge - lounge	138	70	100
Social House	160	80	140
Social House - lounge	76	32	70
Social House - cabana	98	24	50
Waves Buffet Restaurant	300	200	-

MEETING ROOM / LEVEL	SQ M	BANQUET	THEATRE	CABARET	CLASS ROOM	U-SHAPE	BOARDROOM	COCKTAIL
----------------------	------	---------	---------	---------	------------	---------	-----------	----------

**LEVEL 1**

Osprey 1	145	160	180	80	120	-	-	300
Osprey 2	90	60	80	40	50	30	30	100
Osprey Ballroom	330	250	300	150	180	-	-	400
Rosella Boardroom	30	-	-	-	-	-	10	-
Brolga Room	84	40	35	32	24	16	20	100
Corella Room	73	50	60	36	32	24	24	80
Egret Room	59	40	30	24	24	21	24	50

# Conference Floor Plan and Capacities

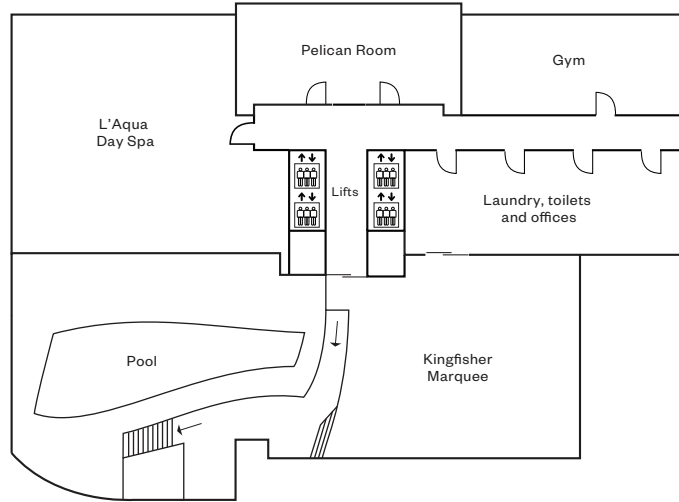

**LEVEL 2**

MEETING ROOM NAME	SQ M	BANQUET	THEATRE	CABARET	CLASS ROOM	U-SHAPE	BOARDROOM	COCKTAIL
<b>LEVEL 2</b>								
Kingfisher Marquee	121	60	-	-	-	-	-	80
Pelican Room	58	40	30	24	20	21	24	50

# VOCO™

AN IHG® HOTEL

**Gold Coast**

31 Hamilton Ave, Surfers Paradise, QLD 4217, Australia  
 (+61) 7 5588 8330  
 events.vocogo@ihg.com  
 goldcoast.vocohotels.com

Drawings are not to scale